

ADD: 浙江省台州市仙居县安州街道西泉路11号
TEL: +86-576-89370768
Mobile: +86-13656579545
FAX: +86-576-89370769
E-mail: leo@xjetl.com

台州永畅液压机械有限公司
Taizhou Eternal Hydraulic Machine Co.,Ltd.

KP1505A dump truck lifting gear pump.....	1
KP1405A dump truck lifting gear pump.....	2
KP1403A dump truck lifting gear pump.....	3
KP1505A-R dump truck lifting gear pump.....	4
KP1405A -R dump truck lifting gear pump.....	5
KP1403A -R dump truck lifting gear pump.....	6
KP1302B dump truck lifting gear pump.....	7
KP75A dump truck lifting gear pump.....	8
KP75B dump truck lifting gear pump.....	9
KP75S dump truck lifting gear pump.....	10
KP55 dump truck lifting gear pump.....	11
GPG55dump truck lifting gear pump.....	12
KP35B dump truck lifting gear pump.....	13
SGP1 series gear pump.....	14
SGP2 series gear pump.....	17
KZP4/KRP4 series gear pump.....	20
DSG06 series gear pump.....	22

KP1505A dump truck lifting gear pumps

KP1505A lifting gear pumps are mainly applied in 10-20 tons dump truck hydraulic system as the hydraulic power source of bucket cylinder. Adopting the material of high strength casting iron and the advanced technology of double metal side plates with special structure to connect control-valve, return-valve and pump as a whole body, the pumps are featured of strong resistance of high working pressure, long lifetime, smart and simple hydraulic system as integration of pump and valve, which makes the pump being the ideal power source of dump truck hydraulic system

Layout

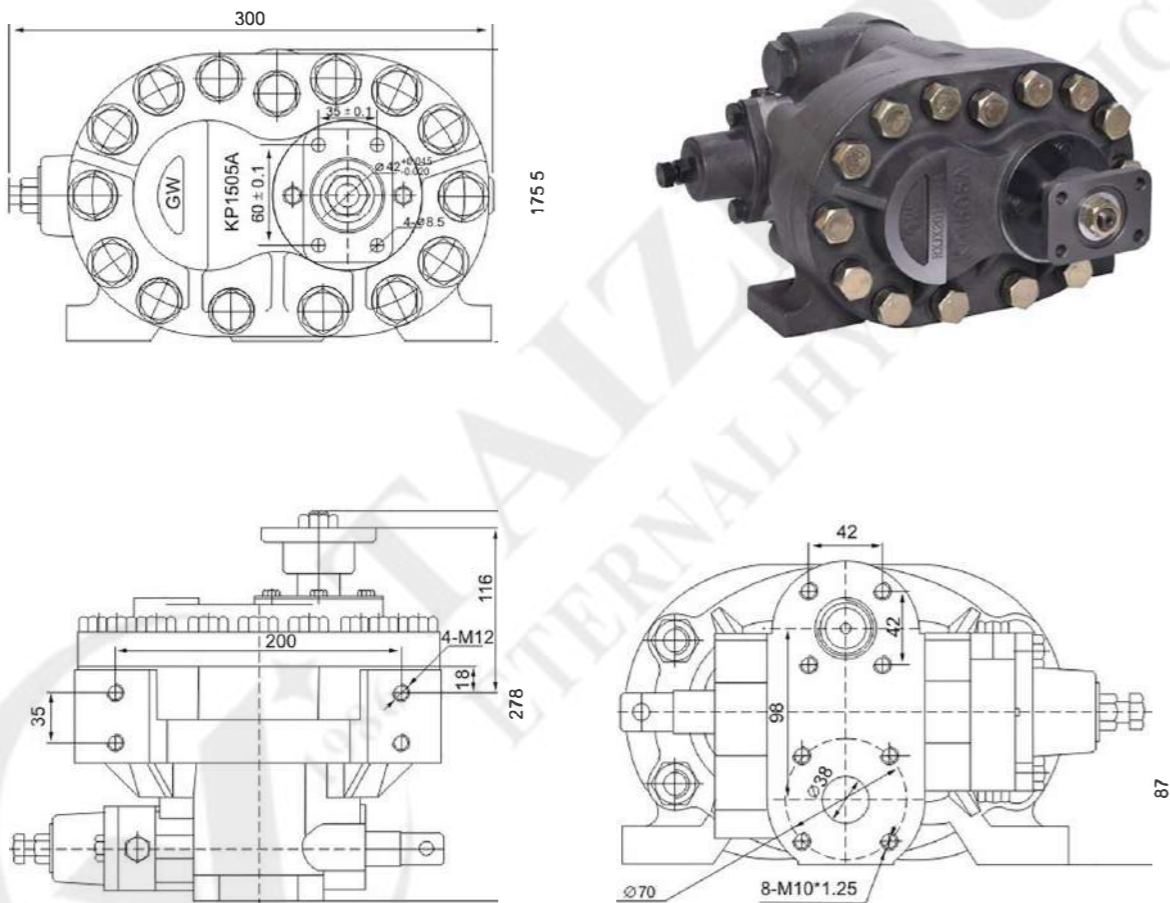

Performance parameter

Theoretical displacement: 150ml/r
Rated pressure: 80kgf /cm²
Steel cable force of controlling valve: 15 kg
Total weight of oil pump: 38 kg
Max pressure: 210 kg/cm²

Working conditions

The temperature of hydraulic oil: -20℃ -80 ℃
Viscosity of hydraulic oil: 10 -75c.s.t
Oil filter precision: ≤25um
Oil suction height: ≤500mm
Drive: use flexible coupling by direct drive
Direction of rotation: counterclockwise (from shaft end of pump)

KP1405A dump truck lifting gear pumps

KP1405A lifting gear pumps are mainly applied in 10-20 tons dump truck hydraulic system as the hydraulic power source of bucket cylinder. Adopting the material of high strength casting iron and the advanced technology of double metal side plates with special structure to connect control-valve, return-valve and pump as a whole body, the pumps are featured of strong resistance of high working pressure, long lifetime, smart and simple hydraulic system as integration of pump and valve, which makes the pump being the ideal power source of dump truck hydraulic system.

Layout

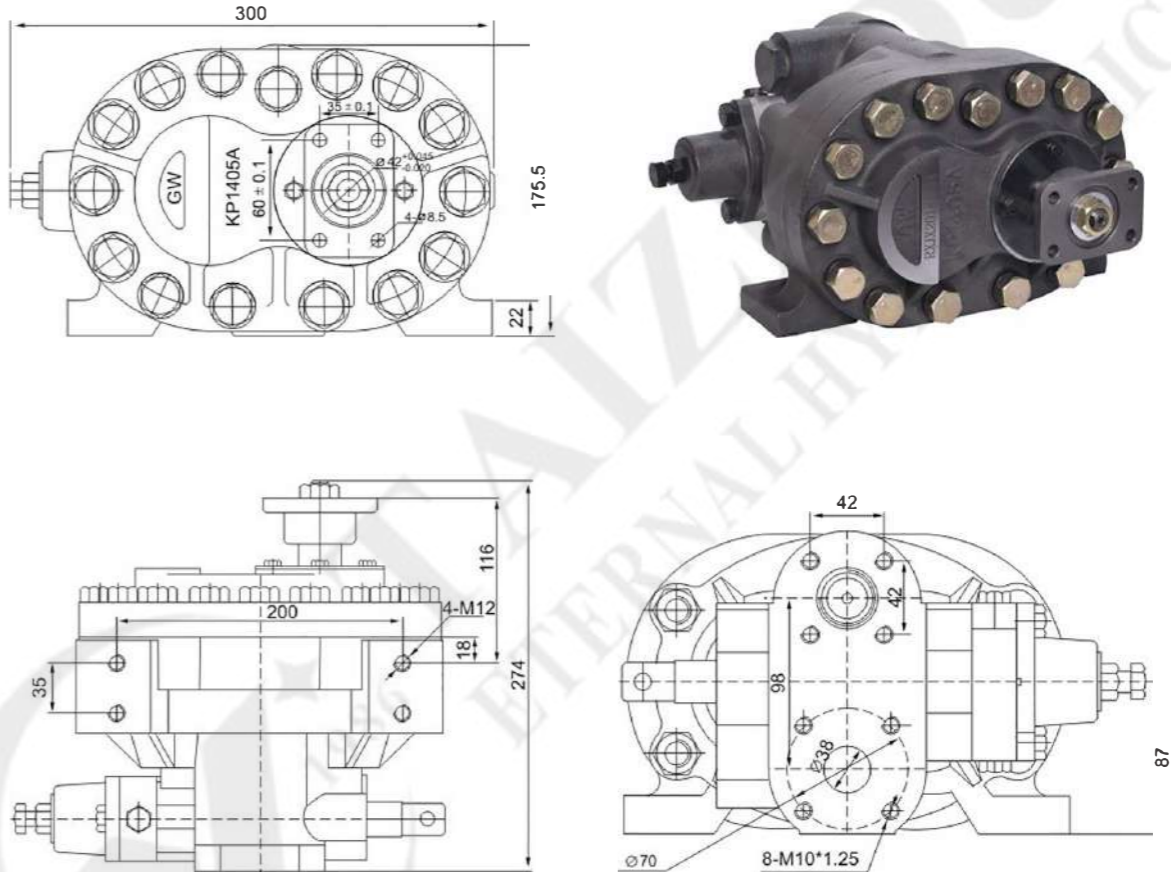

Performance parameter

Theoretical displacement: 140ml/r
Rated pressure: 80kgf /cm²
Steel cable force of controlling valve: 15 kg
Total weight of oil pump: 37 kg
Max pressure: 210 kg/cm²

Working conditions

The temperature of hydraulic oil: -20℃ -80 ℃
Viscosity of hydraulic oil: 10 -75c.s.t
Oil filter precision: ≤25um
Oil suction height: ≤500mm
Drive: use flexible coupling by direct drive
Direction of rotation: counterclockwise (from shaft end of pump)

KP1403A dump truck lifting gear pumps

KP1403A lifting gear pumps are mainly applied in 10-20 tons dump truck hydraulic system as the hydraulic power source of bucket cylinder. Adopting the material of high strength casting iron and the advanced technology of double metal side plates with special structure to connect control-valve, return-valve and pump as a whole body, the pumps are featured of strong resistance of high working pressure, long lifetime, smart and simple hydraulic system as integration of pump and valve, which makes the pump being the ideal power source of dump truck hydraulic system

Layout

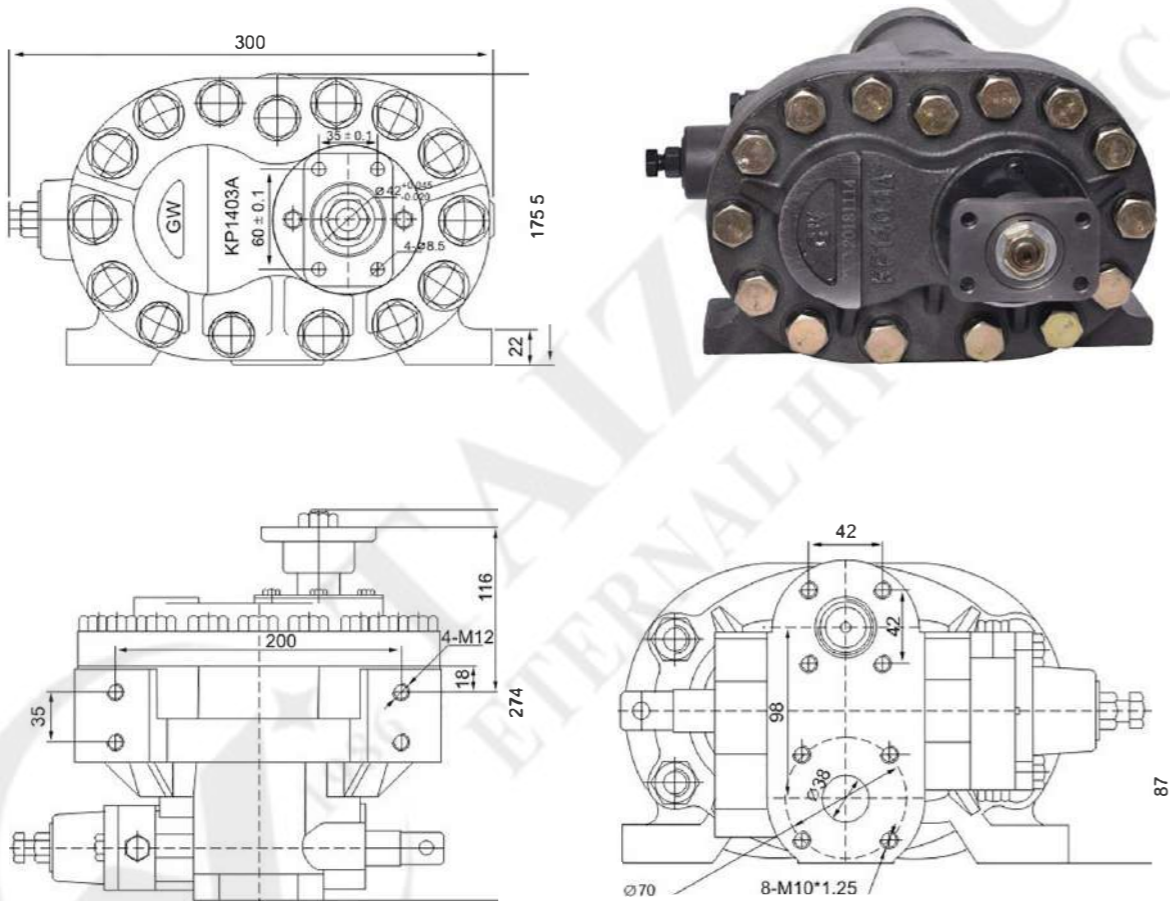

Performance parameter

Theoretical displacement: 140ml/r
Rated pressure: 80kgf /cm²
Steel cable force of controlling valve: 15 kg
Total weight of oil pump: 37 kg
Max pressure: 210 kg/cm²

Working conditions

The temperature of hydraulic oil: -20℃ -80 ℃
Viscosity of hydraulic oil: 10 -75c.s.t
Oil filter precision: ≤25um
Oil suction height: ≤500mm
Drive: use flexible coupling by direct drive
Direction of rotation: counterclockwise (from shaft end of pump)

KP1505A-R dump truck lifting gear pumps

KP1505A-R lifting gear pumps are mainly applied in 10-20 tons dump truck hydraulic system as the hydraulic power source of bucket cylinder. Adopting the material of high strength casting iron and the advanced technology of double metal side plates with special structure to connect control-valve, return-valve and pump as a whole body, the pumps are featured of strong resistance of high working pressure, long lifetime, smart and simple hydraulic system as integration of pump and valve, which makes the pump being the ideal power source of dump truck hydraulic system.

Layout

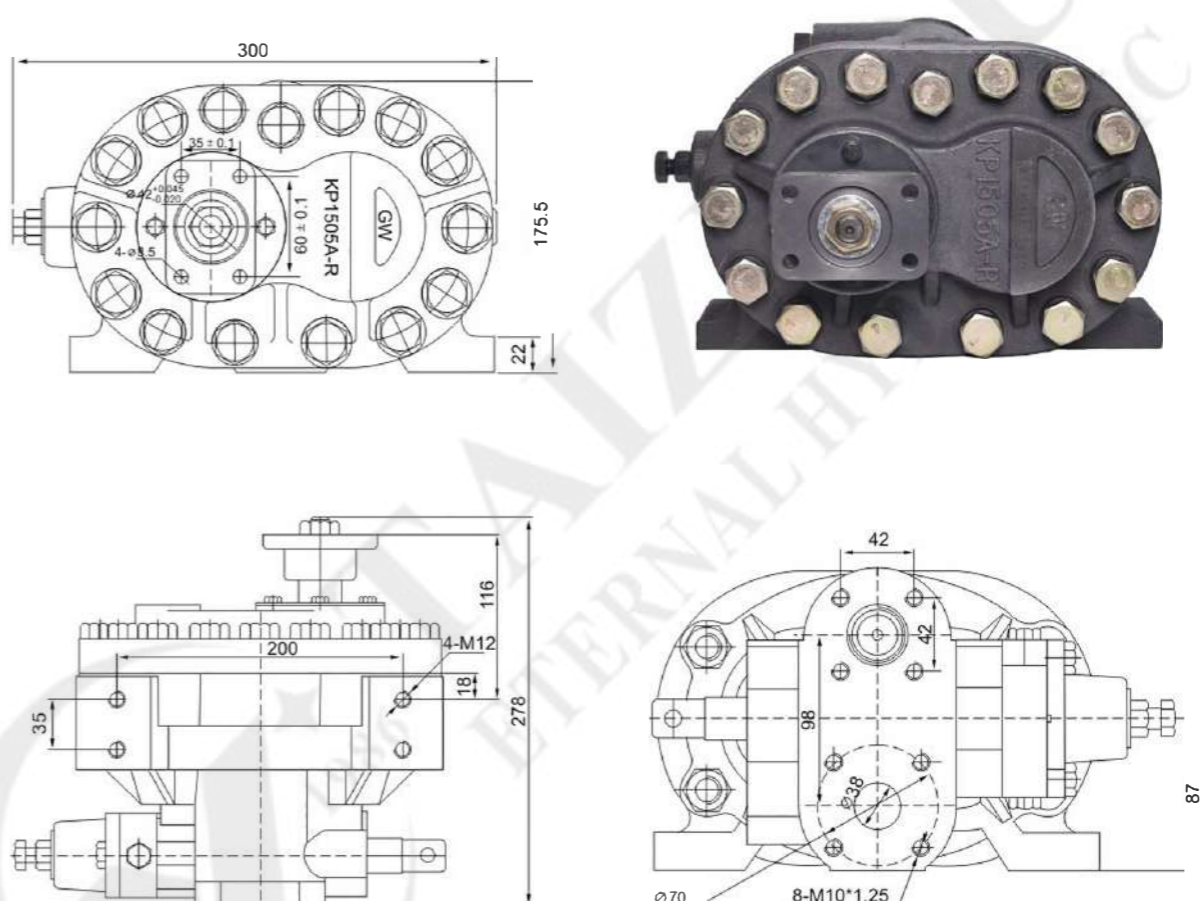

Performance parameter

Theoretical displacement: 140ml/r
Rated pressure: 80kgf /cm²
Steel cable force of controlling valve: 15 kg
Total weight of oil pump: 37 kg
Max pressure: 210 kg/cm²

Working conditions

The temperature of hydraulic oil: -20℃ -80 ℃
Viscosity of hydraulic oil: 10 -75c.s.t
Oil filter precision: ≤25um
Oil suction height: ≤500mm
Drive: use flexible coupling by direct drive
Direction of rotation: clockwise (from shaft end of pump)

KP1405A-R dump truck lifting gear pumps

KP1405A-R lifting gear pumps are mainly applied in 10-20 tons dump truck hydraulic system as the hydraulic power source of bucket cylinder. Adopting the material of high strength casting iron and the advanced technology of double metal side plates with special structure to connect control-valve, return-valve and pump as a whole body, the pumps are featured of strong resistance of high working pressure, long lifetime, smart and simple hydraulic system as integration of pump and valve, which makes the pump being the ideal power source of dump truck hydraulic system

Layout

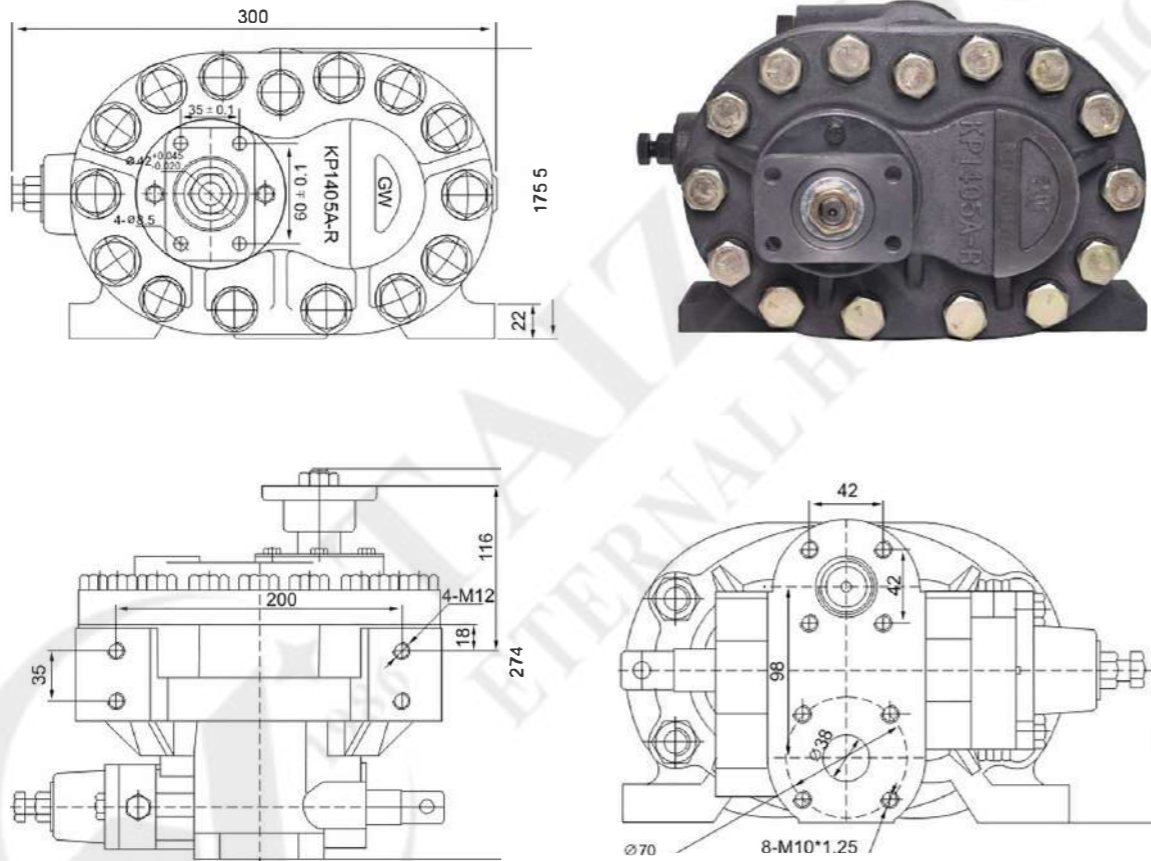

Performance parameter

Theoretical displacement: 140ml/r
Rated pressure: 80kgf /cm²
Steel cable force of controlling valve: 15 kg
Total weight of oil pump: 37 kg
Max pressure: 210 kg/cm²

Working conditions

The temperature of hydraulic oil: -20℃ -80 ℃
Viscosity of hydraulic oil: 10 -75c.s.t
Oil filter precision: ≤ 25um
Oil suction height: ≤ 500mm
Drive: use flexible coupling by direct drive
Direction of rotation: clockwise (from shaft end of pump)

KP1403A-R dump truck lifting gear pumps

KP1403A-R lifting gear pumps are mainly applied in 10-20 tons dump truck hydraulic system as the hydraulic power source of bucket cylinder. Adopting the material of high strength casting iron and the advanced technology of double metal side plates with special structure to connect control-valve, return-valve and pump as a whole body, the pumps are featured of strong resistance of high working pressure, long lifetime, smart and simple hydraulic system as integration of pump and valve, which makes the pump being the ideal power source of dump truck hydraulic system.

Layout

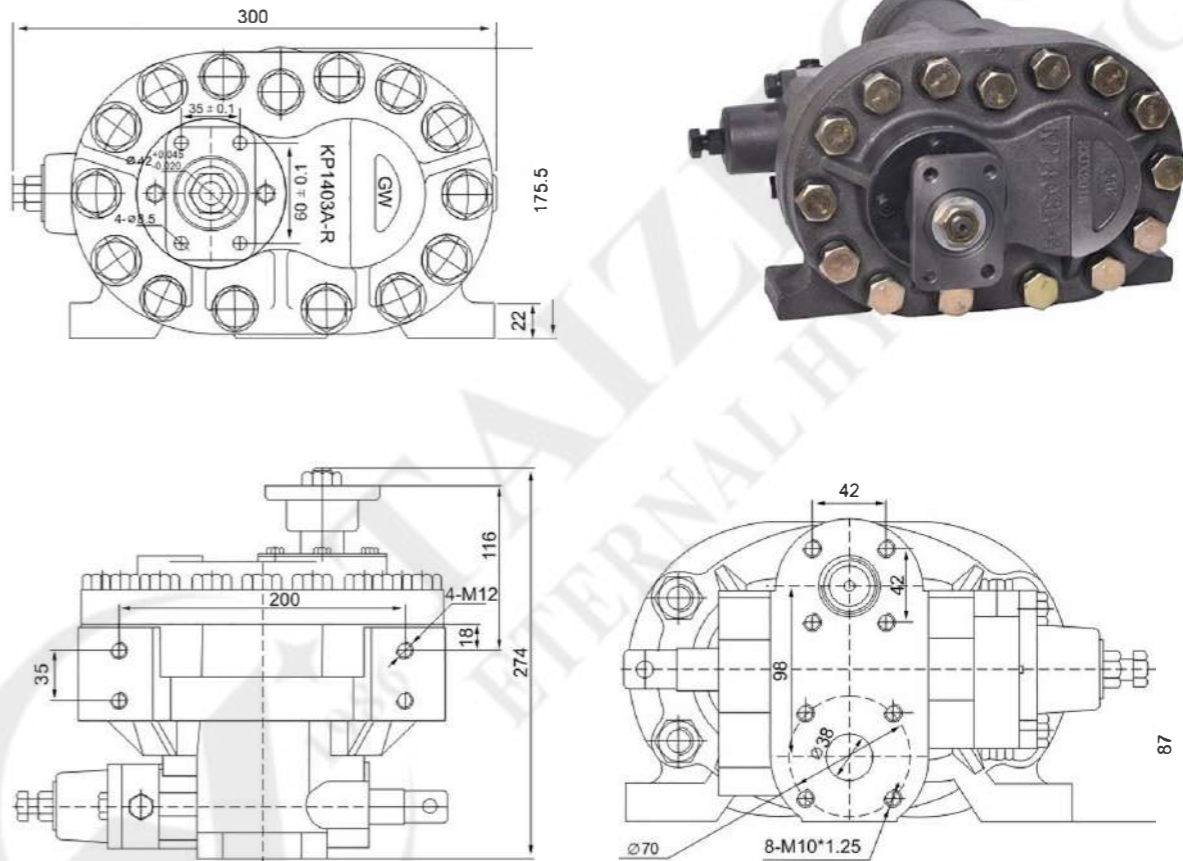

Performance parameter

Theoretical displacement: 140ml/r
Rated pressure: 80kgf /cm²
Steel cable force of controlling valve: 15 kg
Total weight of oil pump: 37 kg
Max pressure: 210 kg/cm²

Working conditions

The temperature of hydraulic oil: -20℃ -80 ℃
Viscosity of hydraulic oil: 10 -75c.s.t
Oil filter precision: ≤ 25um
Oil suction height: ≤ 500mm
Drive: use flexible coupling by direct drive
Direction of rotation: clockwise (from shaft end of pump)

KP1302B dump truck lifting gear pumps

Performance parameters

Geometric displacement: 130ml/r
Rated pressure: 80kgf/cm²
Steel cable force of controlling valve: 15 kg
Total weight of oil pump: 38 kg

Working conditions

The temperature of hydraulic oil: -20℃-80℃
Viscosity of hydraulic oil: 10-75cst
Oil filter precision: ≤25um
Oil absorption rate: ≤500mm
Drive: use flexible coupling by direct drive
Direction of rotation: counter clockwise (from shaft end of pump)



Layout

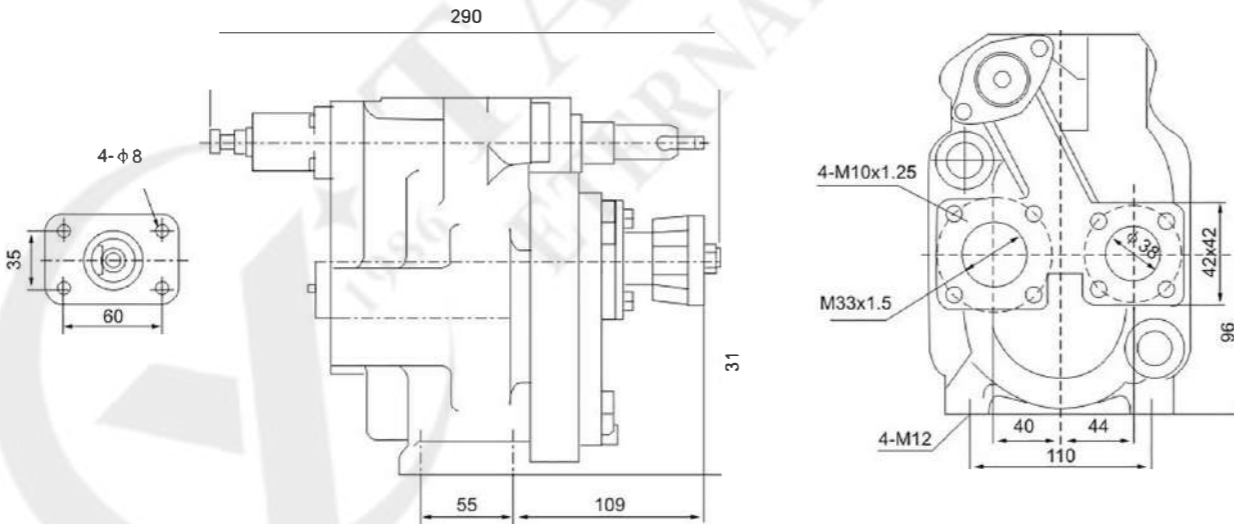

KP75A dump truck lifting gear pump

KP75A lifting gear pumps are mainly applied in 6-10 tons dump truck hydraulic system as the hydraulic power source of bucket cylinder. Adopting the material of high strength casting iron and the advanced technology of double metal side plates with special structure to connect control-valve, return-valve and pump as a whole body, the pumps are featured of strong resistance of high working pressure, long lifetime, smart and simple hydraulic system as integration of pump and valve, which makes the pump being the ideal power source of dump truck hydraulic system.

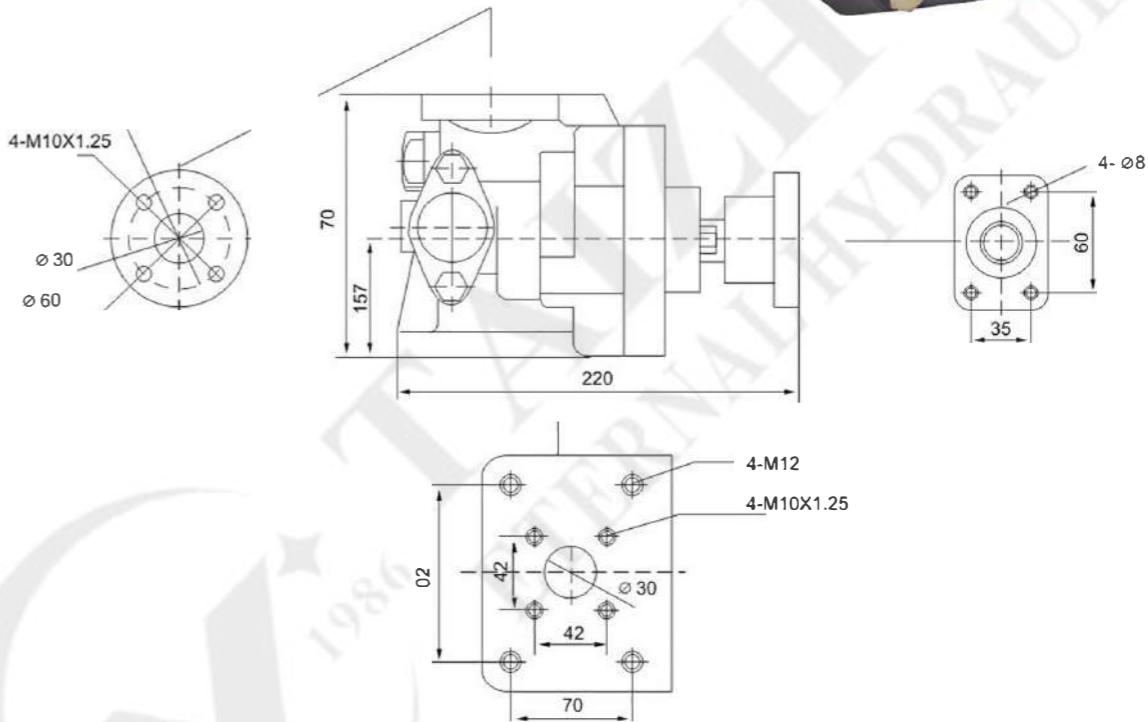

Performance parameters

Theoretical displacement: 75ml/r
Rated revolution: 800 rpm
Max testing pressure: 210kgf/cm²
Max revolution: 1800rpm
Steel cable force of controlling valve: 14 kg
Total weight of oil pump: 21 kg

Working conditions

The temperature of hydraulic oil -20℃ -80℃
Viscosity of hydraulic oil: 10~75c.s.t
Oil filter precision: ≤ 25um
Oil suction height: ≤ 500mm
Drive: use flexible coupling by direct drive
Direction of rotation: counterclockwise (from shaft end of pump)

KP75B dump truck lifting gear pump



KP75B lifting gear pumps are mainly applied in 6-10 tons dump truck hydraulic system as the hydraulic power source of bucket cylinder. Adopting the material of high strength casting iron and the advanced technology of double metal side plates with special structure to connect control-valve, return-valve and pump as a whole body, the pumps are featured of strong resistance of high working pressure, long lifetime, smart and simple hydraulic system as integration of pump and valve, which makes the pump being the ideal power source of dump truck hydraulic system.

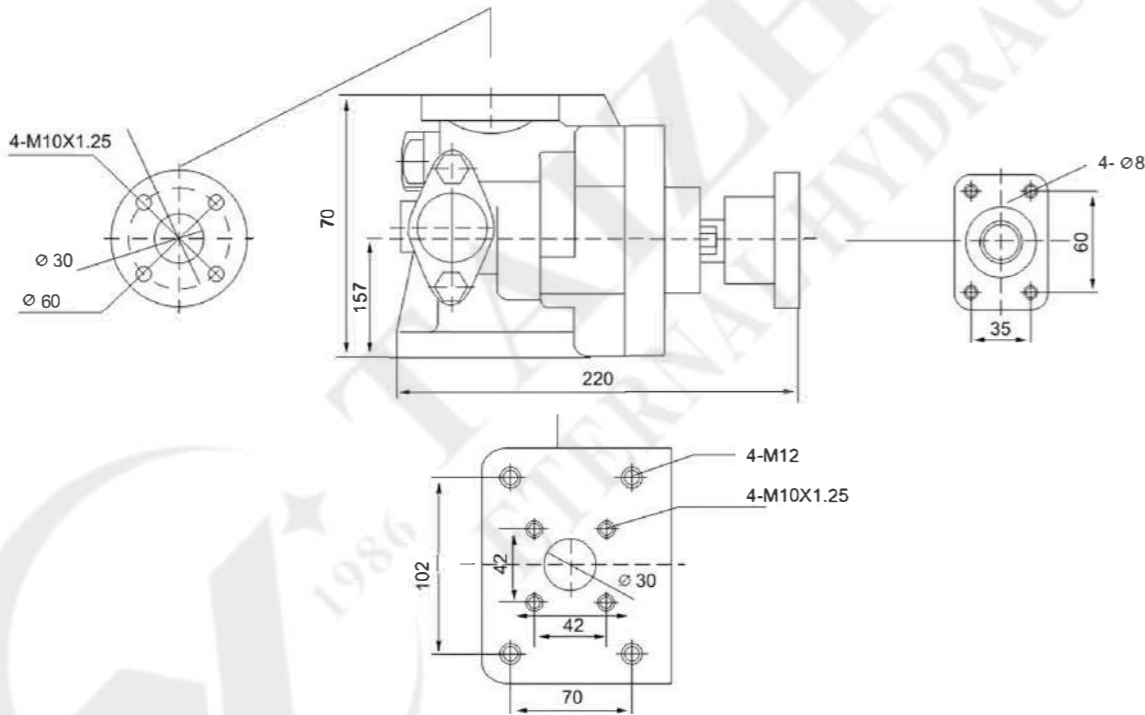

Performance parameters

Theoretical displacement: 75ml/r Rated pressure: 70kgf /cm²
Rated revolution: 800 rpm Mini revolution: 350 rpm
Max testing pressure: 210kgf/cm²
Max revolution: 1800rpm
Steel cable force of controlling valve: 14 kg
Total weight of oil pump: 21 kg

Working conditions

The temperature of hydraulic oil -20℃ -80 ℃
Viscosity of hydraulic oil: 10~75c.s.t
Oil filter precision: ≤25um
Oil suction height: ≤500mm
Drive: use flexible coupling by direct drive
Direction of rotation: counterclockwise (from shaft end of pump)

KP75S dump truck lifting gear pump



KP75S lifting gear pumps are developed for the market in Southeast Asia. The position of valve rod is the same as KPI403 and KP55. The pumps are mainly applied in 6-10 tons dump truck hydraulic system as the hydraulic power source of bucket cylinder. Adopting the material of high strength casting iron and the advanced technology of double metal side plates with special structure to connect control-valve, return-valve and pump as a whole body, the pumps are featured of strong resistance of high working pressure, long lifetime, smart and simple hydraulic system as integration of pump and valve, which makes the pump being the ideal power source of dump truck hydraulic system.

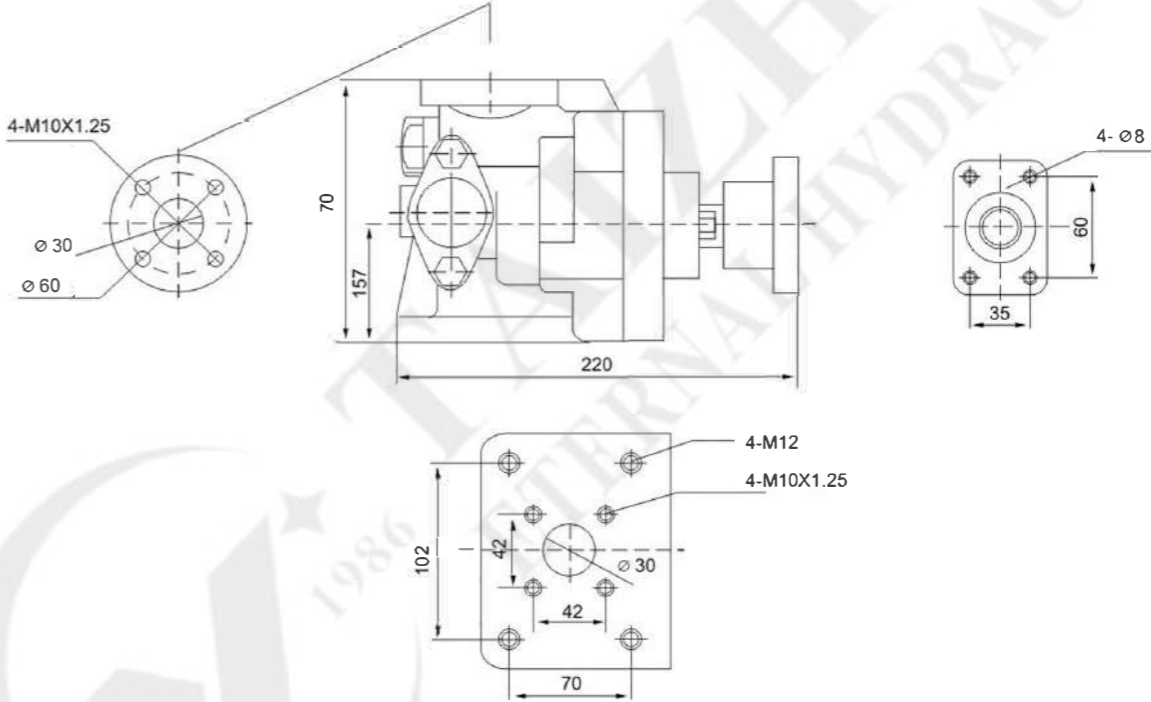

Performance parameters

Theoretical displacement: 75ml/r Rated pressure: 70kgf /cm²
Rated revolution: 800 rpm Mini revolution: 350 rpm
Max testing pressure: 210kgf/cm²
Max revolution: 1800rpm
Steel cable force of controlling valve: 14 kg
Total weight of oil pump: 21 kg

Working conditions

The temperature of hydraulic oil -20℃ -80 ℃
Viscosity of hydraulic oil: 10~75c.s.t
Oil filter precision: ≤25um
Oil suction height: ≤500mm
Drive: use flexible coupling by direct drive
Direction of rotation: counterclockwise (from shaft end of pump)

KP55 dump truck lifting gear pump

KP55 lifting gear pumps are mainly applied in 4-6 tons dump truck hydraulic system as the hydraulic power source of bucket cylinder. Adopting the material of high strength casting iron and the advanced technology of double metal side plates with special structure to connect control-valve, return-valve and pump as a whole body, the pumps are featured of strong resistance of high working pressure, long lifetime, smart and simple hydraulic system as integration of pump and valve, which makes the pump being the ideal power source of dump truck hydraulic system.



Layout

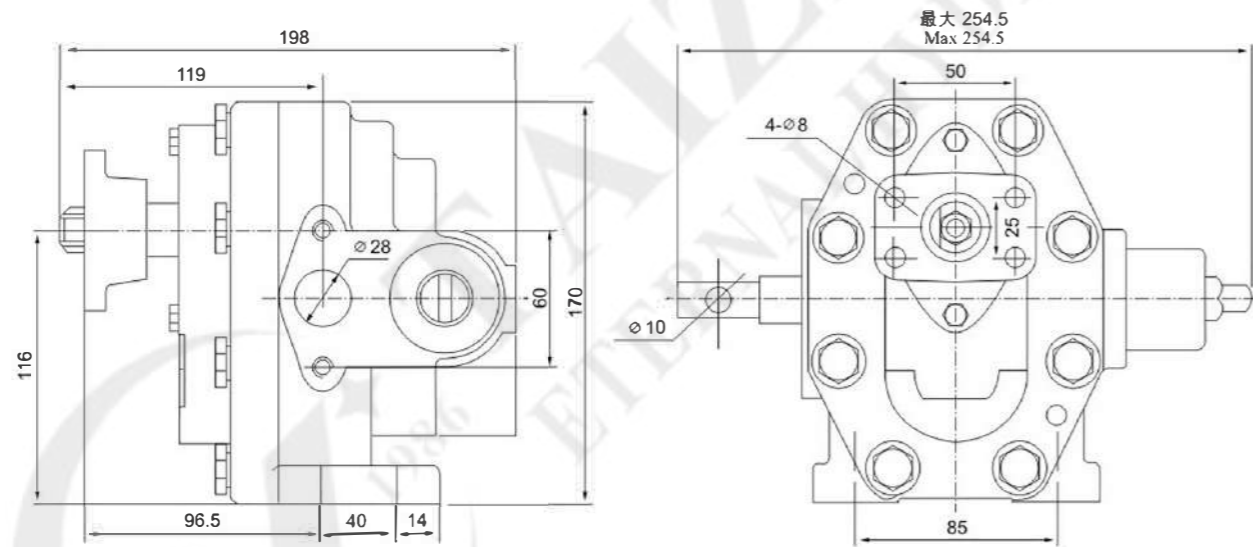

Performance parameters

Theoretical displacement: 55ml/r
Rated pressure: 70kgf/cm²
Steel cable force of controlling valve: 13 kg
Total weight of oil pump: 13 kg

Working conditions

Oil filter precision: ≤25um
Oil suction height: ≤500mm
Drive: use flexible coupling by direct drive
Direction of rotation: counterclockwise (from shaft end of pump)

GPG55 dump truck lifting gear pumps

GPG55 lifting gear pumps are mainly applied in 4-6 tons dump truck hydraulic system as the hydraulic power source of bucket cylinder. Adopting the material of high strength casting iron and the advanced technology of double metal side plates with special structure to connect control-valve, return-valve and pump as a whole body, the pumps are featured of strong resistance of high working pressure, long lifetime, smart and simple hydraulic system as integration of pump and valve, which makes the pump being the ideal power source of dump truck hydraulic system.



Layout

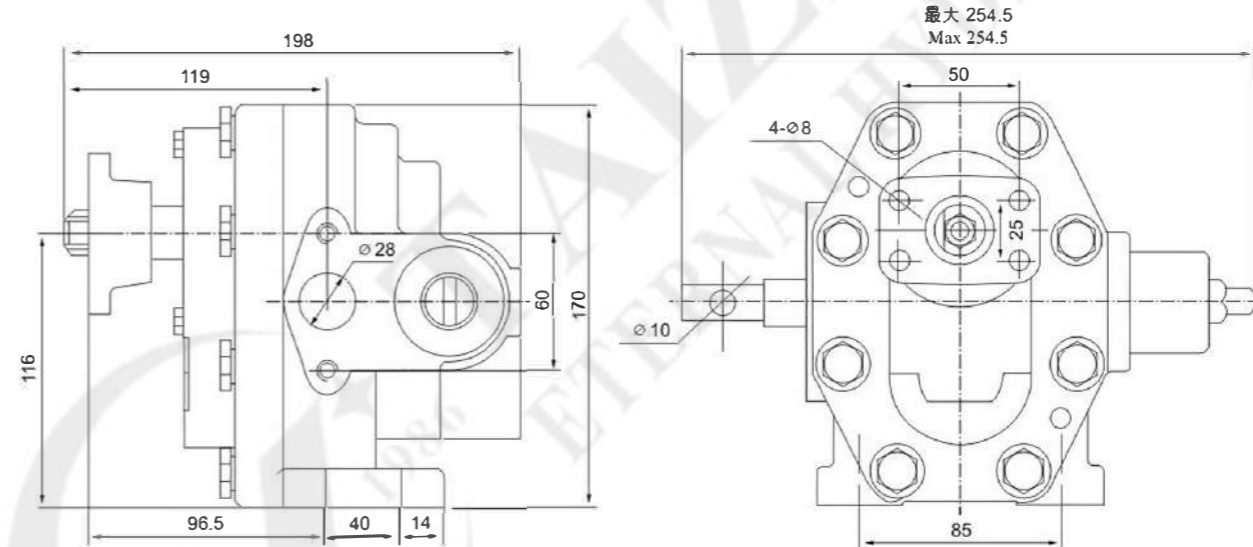

Performance parameters

Theoretical displacement: 55ml/r
Rated pressure: 70kgf/cm²
Steel cable force of controlling valve: 13 kg
Total weight of oil pump: 13 kg

Working conditions

Oil filter precision: ≤25um
Oil suction height: ≤500mm
Drive: use flexible coupling by direct drive
Direction of rotation: counterclockwise (from shaft end of pump)

KP35B dump truck lifting gear pump

KP35B series pumps are mainly applied in the hydraulic system of 4-6 tons capacity dump truck as the hydraulic power source of the bucket cylinder. The bucket can be lifted and lowered by operating the joystick on the control valve, which was assembled with the pump as a whole body in inner-connected way.

Performance parameters

Theoretical Displacement: 35ml/r
Max testing pressure: 175kgf/cm²
Rated pressure: 45kgf/cm²
Force on the steel cable of control valve: 10 kg
Total weight of oil pump: 10 kg



Layout

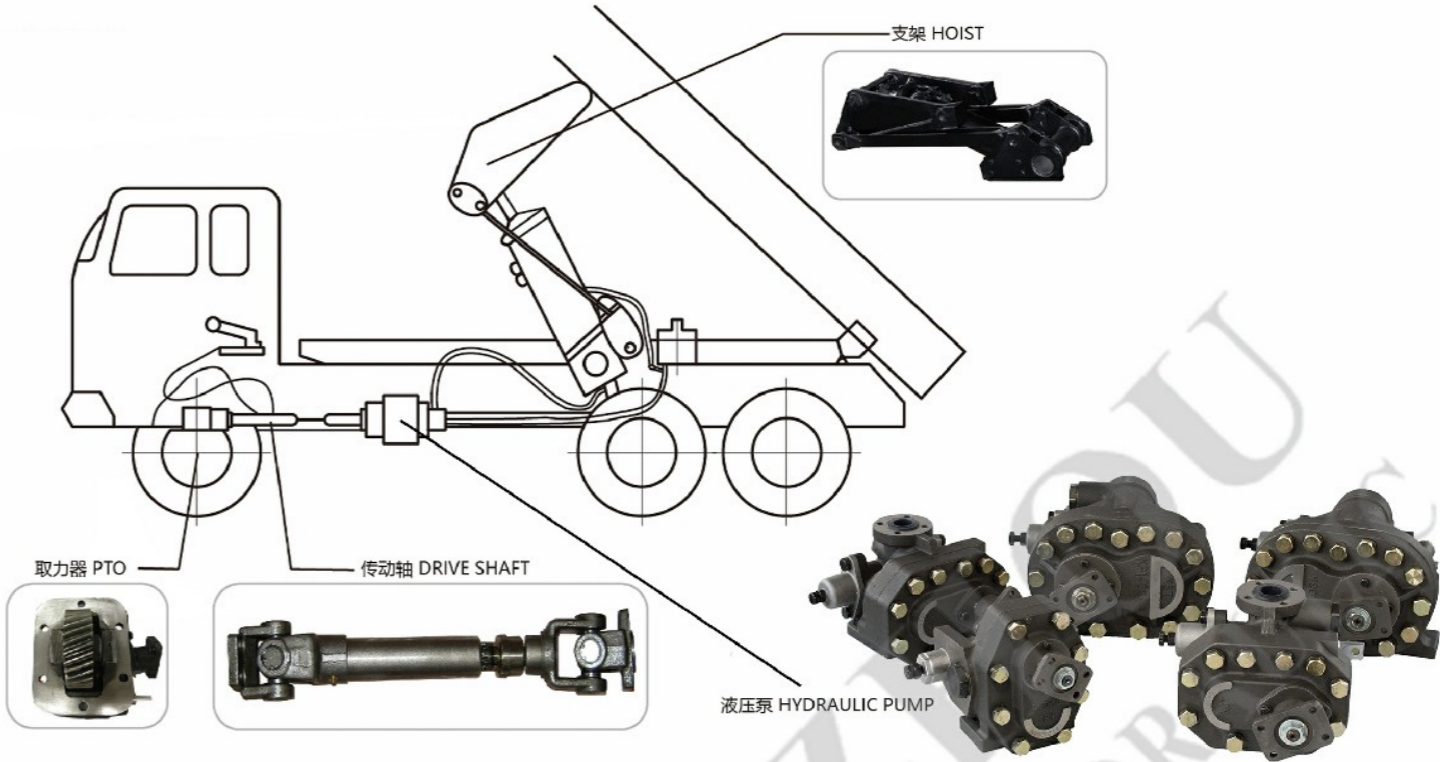
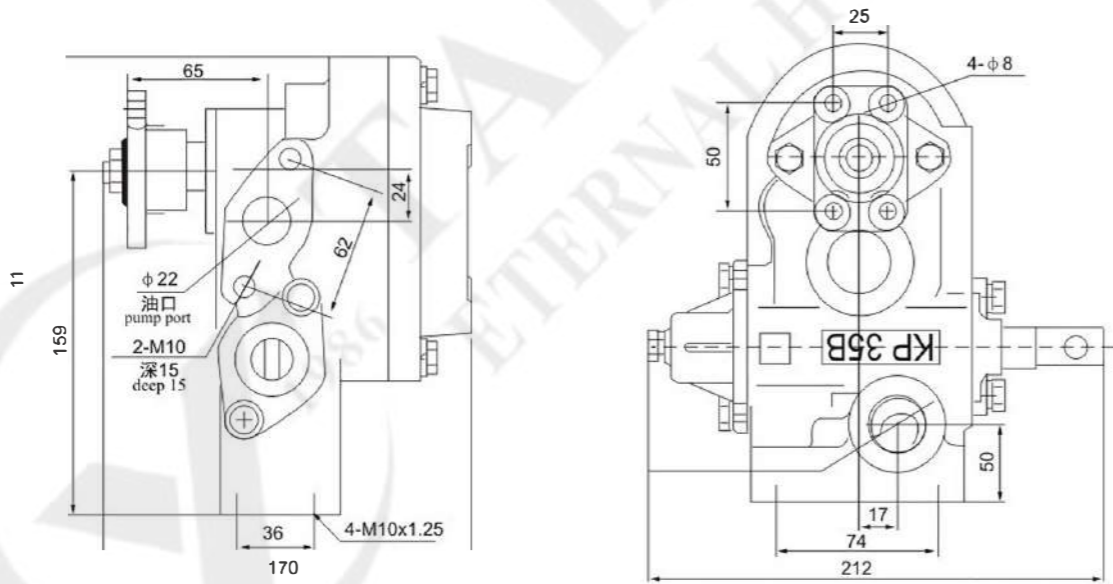

型号 Model	排量 (ml/r) Displace- ment	额定压力 (kgf/cm ²) Rated pressure	转速 Speed (rpm)			最高试验压 力 (kgf/cm ²) Max testing pressure	阀杆作用力 Force on control spool (Kg)	旋向 Rotatio n	重量 (Kg) Weight
			额定 Rated	最低 Min	最高 Max				
KP-35B	35	70	800	350	1800	175	12	Left	10
KP55	55	70	800	350	1800	210	13	Left	13
GPG55	55	70	800	350	1800	210	13	Left	13
KP75A	75	70	800	350	1800	210	14	Left	21
KP75B	75	70	800	350	1800	210	14	Left	21
KP75A-C	75	70	800	350	1800	210	14	Left	21
KP1403A	140	80	800	350	1800	210	15	Left	37
KP1403-R	140	80	800	350	1800	210	15	Right	37
KP1405A	140	80	800	350	1800	210	15	Left	37
KP1405-R	140	80	800	350	1800	210	15	Right	37
KP1505A	150	80	800	350	1800	210	15	Left	38
KPA-1302B	130	80	800	350	1800	210	15	Left	31.5
VC1403	136	80	800	350	1800	210	15	Left	39